

# Avery Aquatic Center

1	Programs/Info Desk	5	JSSL Concessions	15	Finish End of Pool
2	Swimmer Check-in/Table Worker	6	Clerk of Course Upper		
3	Results	13	All Day Worker Lunch Area		
4	First Aid	14	Volunteer Check-in		

## Equipment Set-up

- ★ EZ-ups (18-20)
- Tables
- Chairs

These are approximate numbers. See equipment list for more detail. Map just gives guidance for object placement.

Since non-JSSL vendors and concessions will be outside the Avery gate, at setup time, leave tables, chairs and EZ-ups just inside the gate. In the morning prior to meet start time, get tables, chairs and EZ-ups for vendors and concessions setup if needed.

Day worker lunch area is in the breezeway/stairway beneath the bleachers on the west side of the pool deck

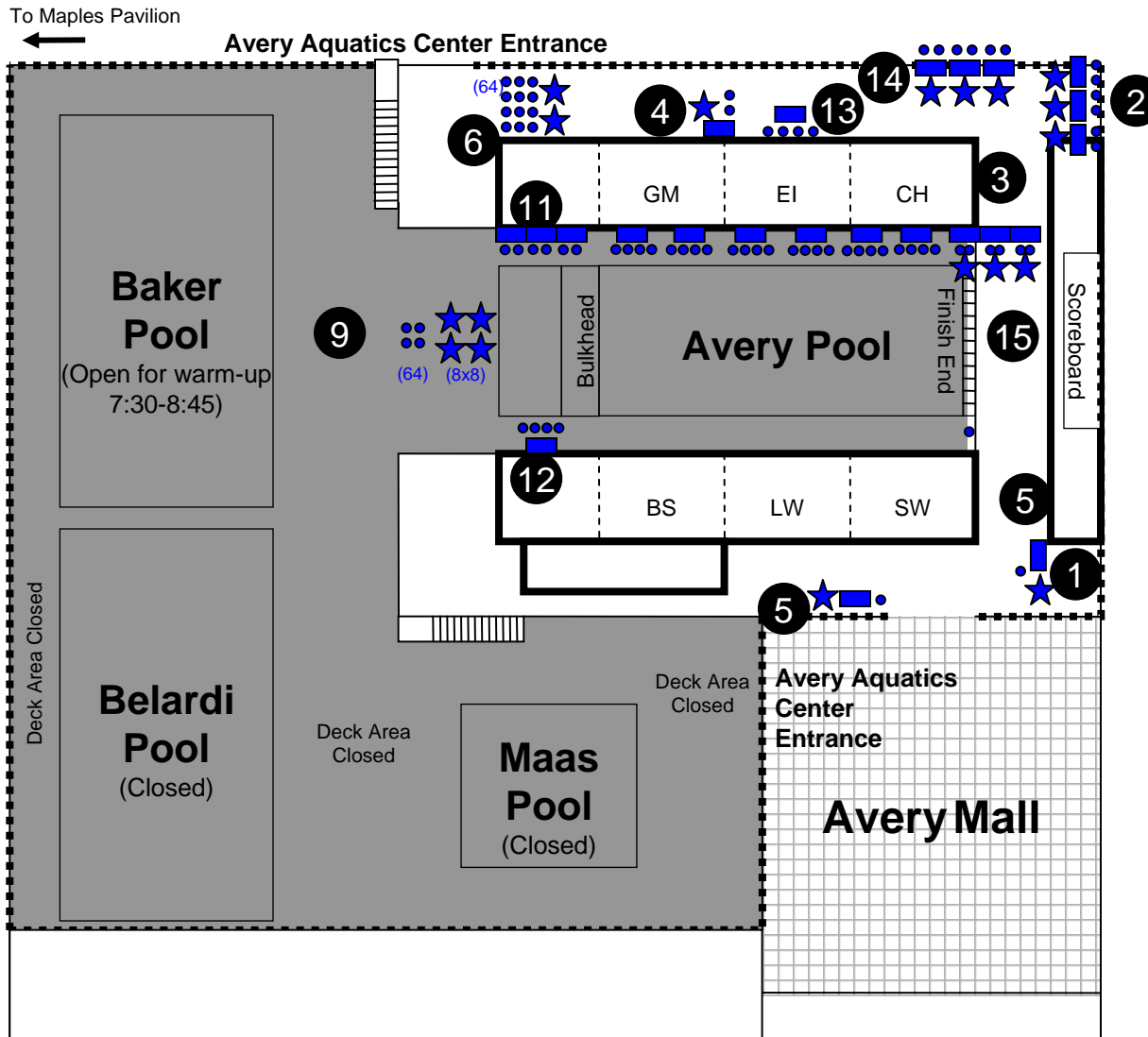

# Avery Aquatic Center

## Key:

- |                                 |                         |
|---------------------------------|-------------------------|
| 1 Programs/Info Desk            | 5 JSSL Concessions      |
| 2 Swimmer Check-in/Table Worker | 6 Clerk of Course Upper |
| 3 Results                       | 14 Volunteer Check-in   |
| 4 First Aid                     | 15 Finish End of Pool   |

To Maples Pavilion

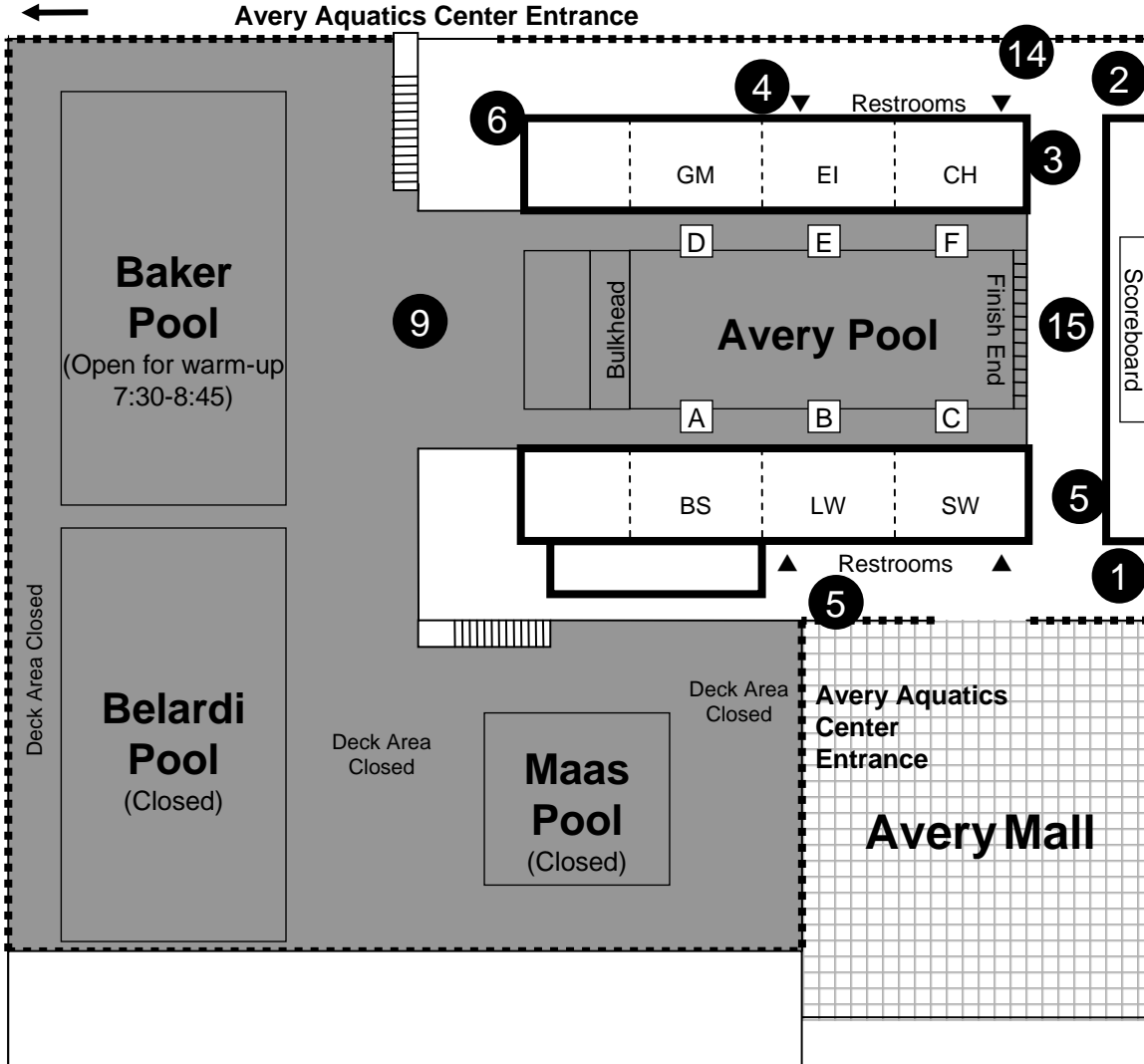



# Meetings

- |             |   |    |
|-------------|---|----|
| 7:00am      | Meet Coordinators   | 14 |
| 7:10am      | Volunteer Check-in  | 14 |
| 7:15am      | Warm-up Marshals meet   | 9  |
| 7:15-8:30am | Volunteers Check-in Pick up tags/passes   | 14 |
| 8:15am      | All Head volunteer Positions Pick up IDs to jobs  | 14 |
| 8:20am      | Stroke & Turn Judges / Referee / Meet Director / False Start Judges                             | E  |
| 8:20am      | All Runners (DQ, Event, Results, Label) meet Head Runner. No Starting block runners             | F  |
| 8:20am      | Clerk of Course / Starting Block runners & workers  | 9  |
| 8:20am      | Timing Console / DQ Reader / Intermediary / Timing Table Collator / Asst. Table meet Head table | D  |
| 8:30am      | All Timers, Recorders meet Head timer   | 15 |
| 8:30am      | Head Referee & Head Coach   |    |
| 8:30am      | 1 <sup>st</sup> and 2 <sup>nd</sup> half Marshals meet Head Marshal                             | C  |
| 8:45am      | All Ribbon workers meet Head ribbon prep  | A  |
|             |   | 2  |
- Revised July 3, 2010

# Avery Aquatic Center

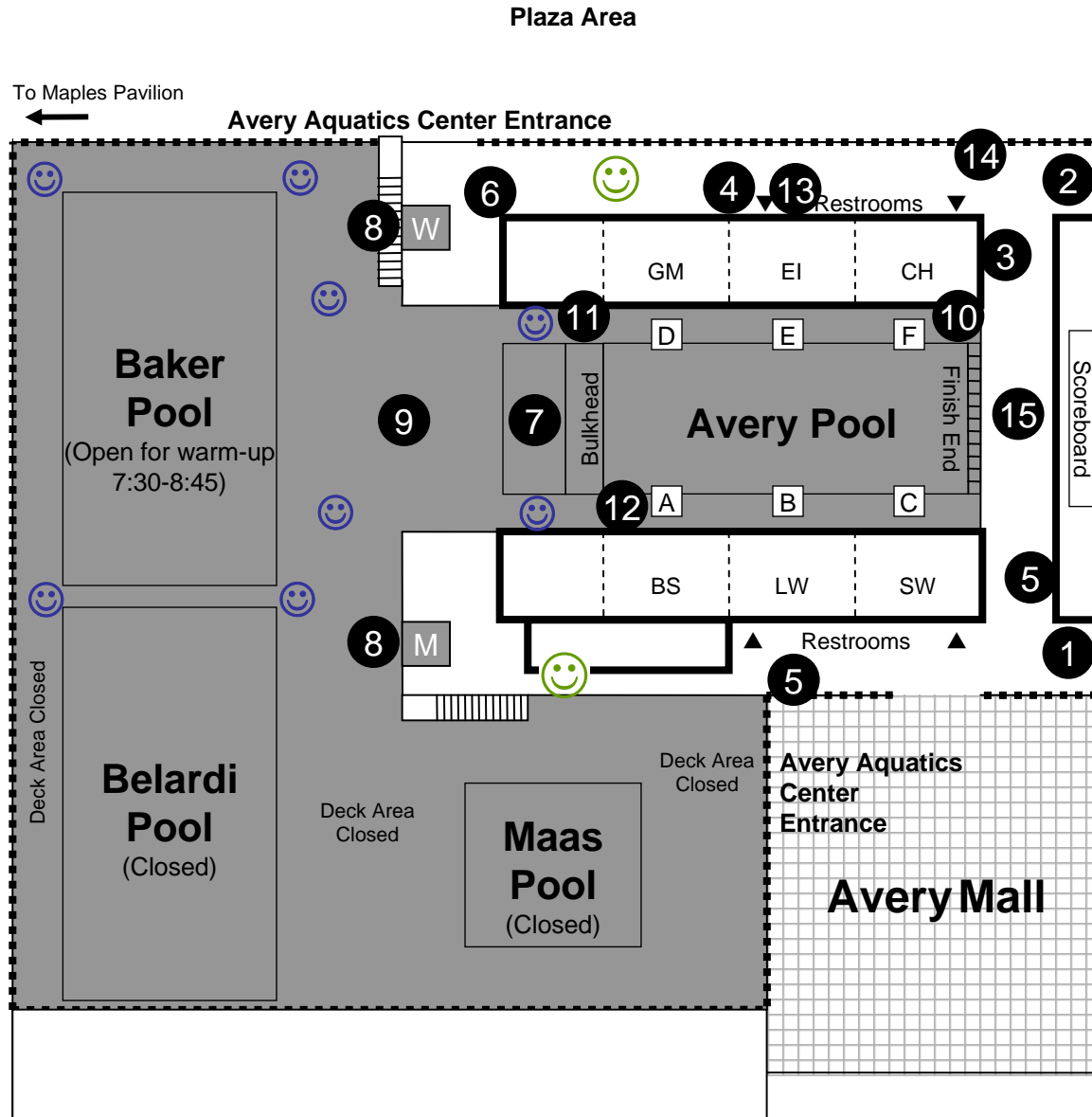
# Map



1. Programs/Info Desk
  2. Swimmer Check-in/Table Worker
  3. Results
  4. First Aid
  5. JSSL Concessions
  6. Clerk of Course (Upper)
  7. Warm-up Area (Ages 11+, After 9am)
  8. Locker-Rooms (at Pool Level)
  9. Clerk of the Course (Lower)
  10. Starting Table
  11. Computer Desk
  12. Hospitality
  13. All Day Worker Lunch Area
  14. Volunteer Check-in
  15. Finish End of Pool
-  Deck Marshal (Lower)  
 Deck Marshal (Upper)

Revised June 28, 2011